

ROVECONCEPTS

Refined Luxury Living



**Georgio Conference Table
ASSEMBLY INSTRUCTIONS**

HARDWARE

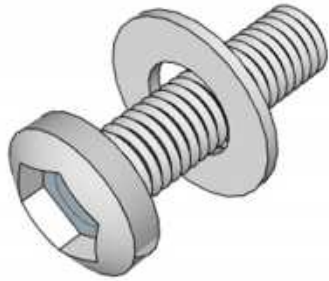

1
×8
M8*40



2
×4
M6*15

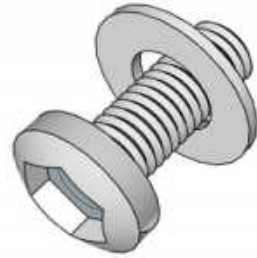

3
×4
M8*15

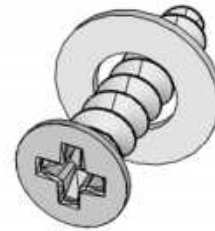

4
×8
M4.2*15

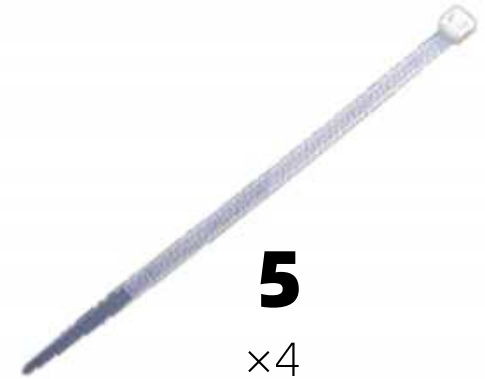

5
×4

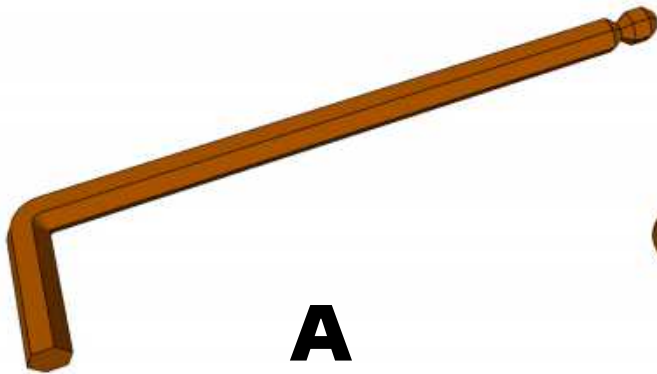

A
×1
M6

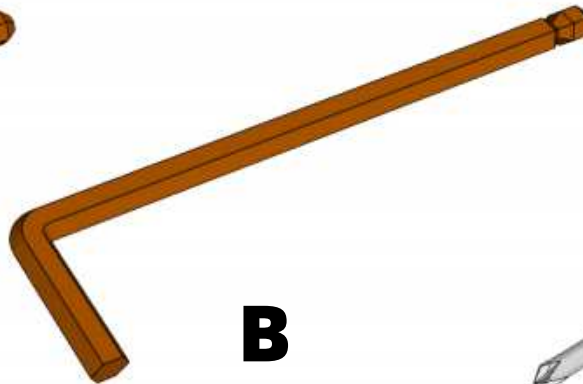

B
×1
M4

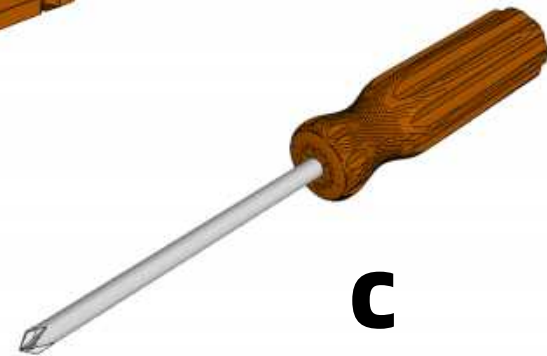

C

STEP 1 ! ! ! In first using or re-work after power off. Pls do reset operation.

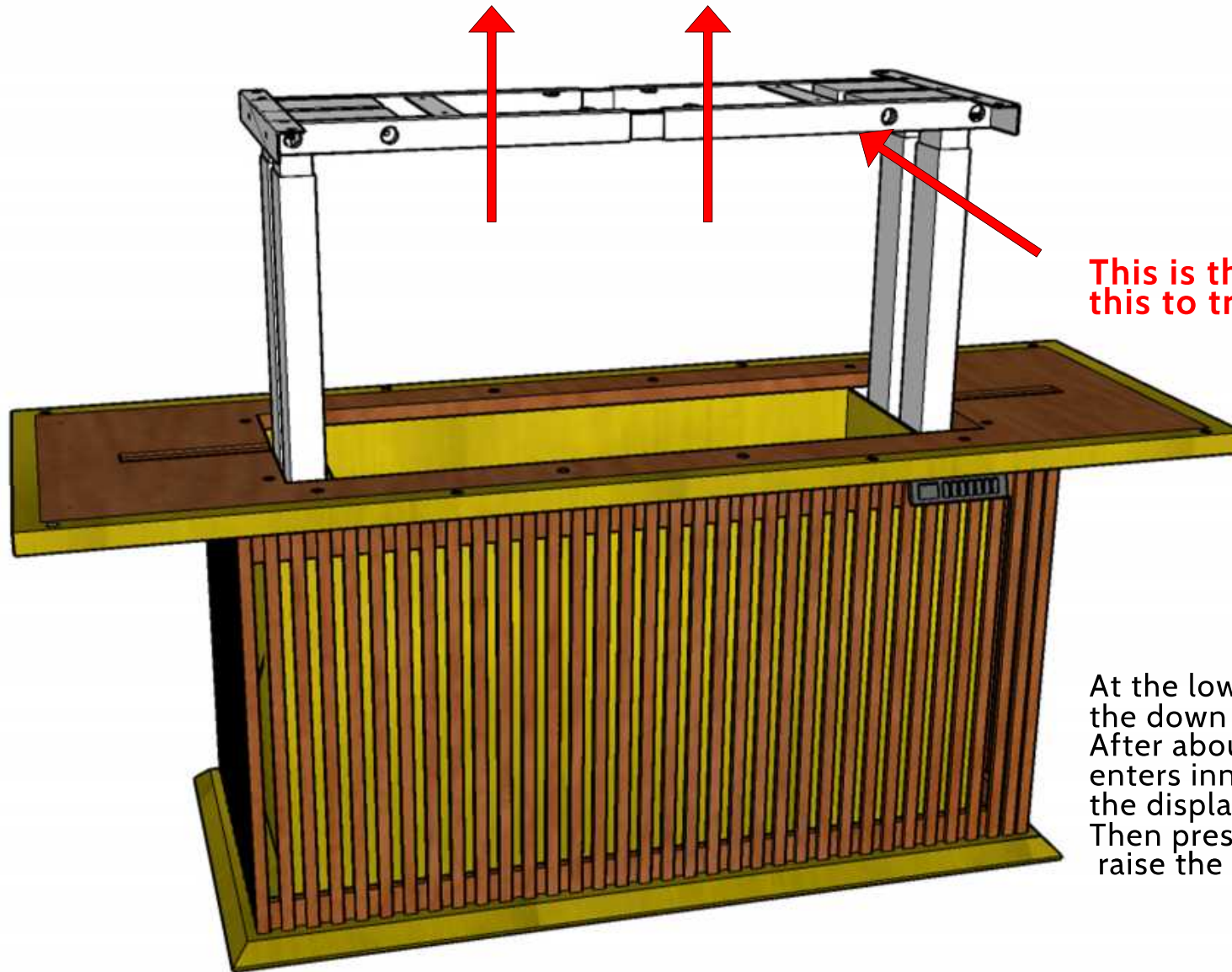

This is the force point. Use this to transfer the BASE.

At the lowest altitude, press and hold the down button "↓". After about 5 seconds, the system enters initialization mode until the display reads 70.0 altitude. Then press the "↑" key to raise the desktop.

STEP 2

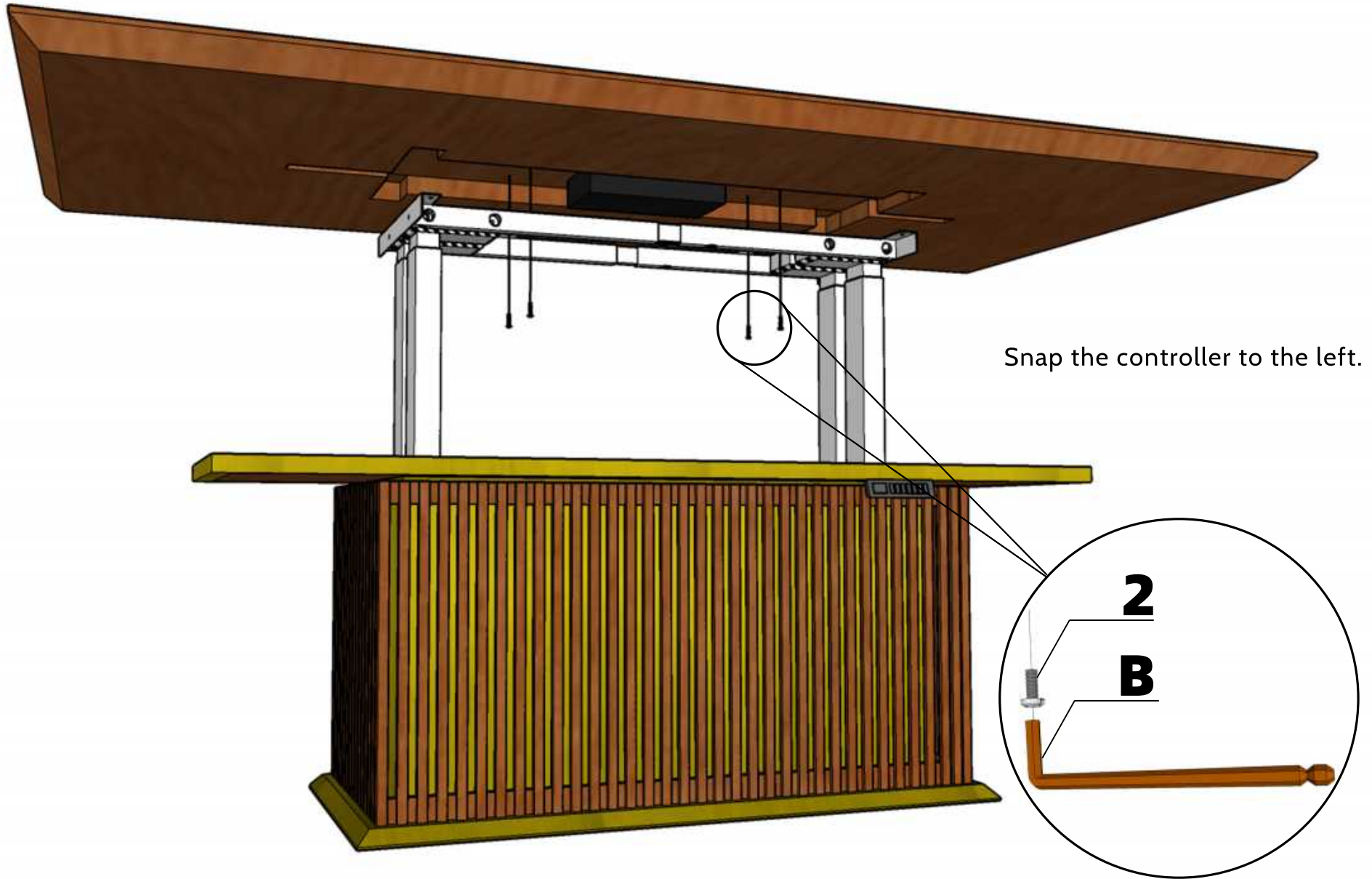

STEP 3



STEP 4

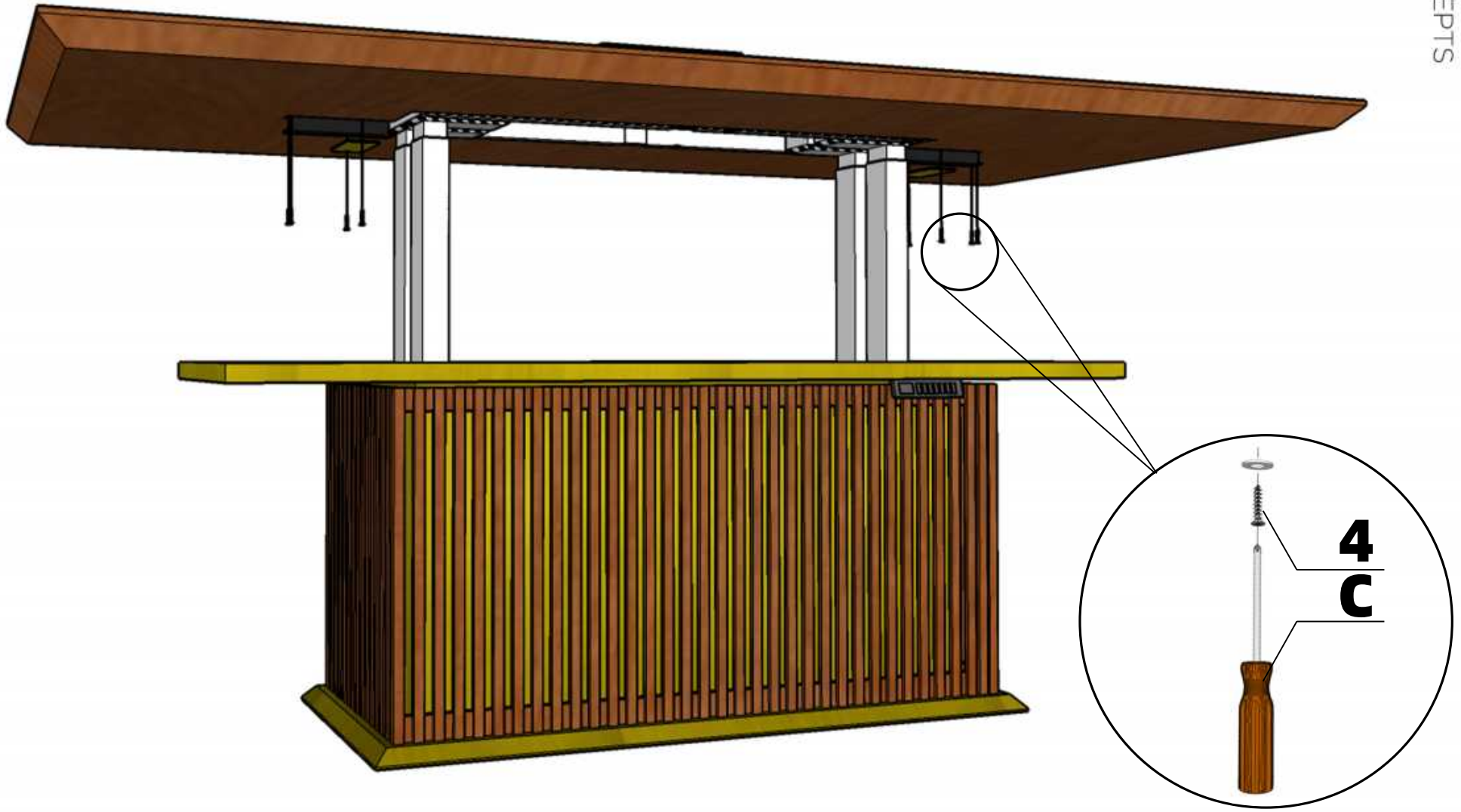

STEP 5

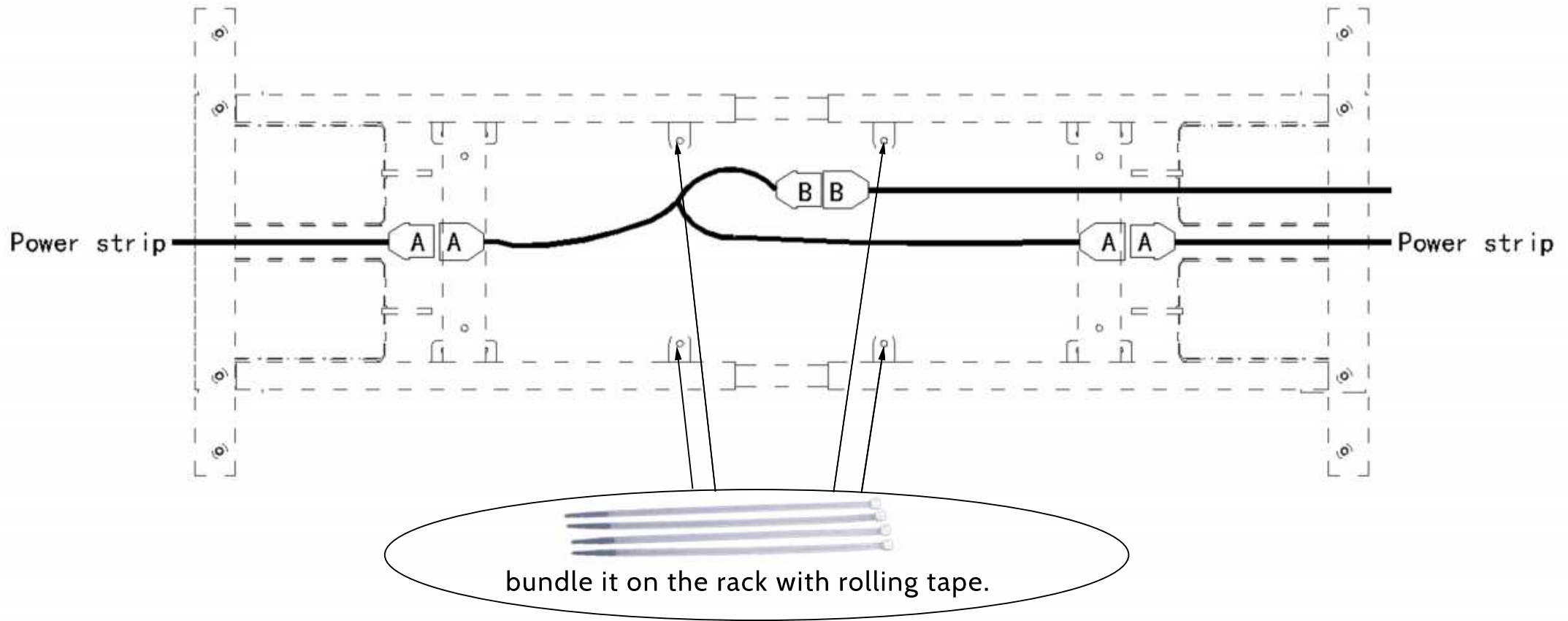

Connect the corresponding wires according to the number.

STEP 6

Press and hold the "↓" key to lower the desktop to its lowest level. Lock the screws.

