

# ROVECONCEPTS

## ROMA PENDANT | ASSEMBLY INSTRUCTIONS

### Step 1



1. Adjust the two mounting housings A into a preferred height position firstly.

### Step 2

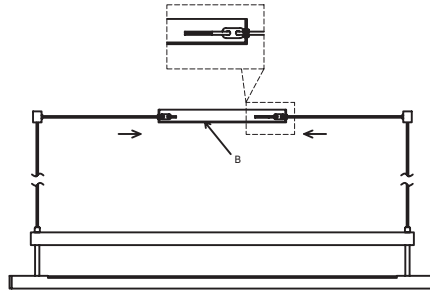

2. Put both left & right power cords through the mounting housing B and then fasten both cords by using the 8 shape knot till firm.

### Step 3

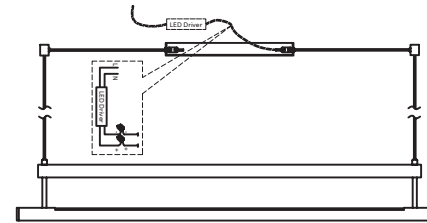

3. Connect the lamp power cords to the driver according to the "+&"&"-. Make sure the positive & negative are correctly wired.

### Step 4

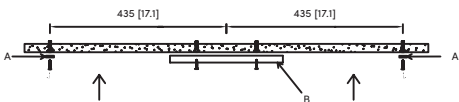

4. Measure the correct mounting positions for housing A & B, and then install the A & B mounting bracket housings on the ceiling

### Step 5

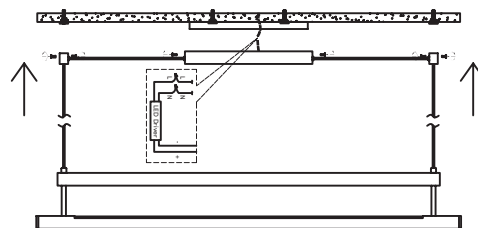

5. Connect the driver cords to the ceiling power cords, make sure "N"(Neutral wire) & "L"(Live wire) are correctly wired. Then fasten the mounting housing A & B on the ceiling mounting bracket housings at the end.

3. Keep the lamp away from curtains, bedding linens, and any other flammable materials.

4. When replacing the bulb turn the lamp off and allow the lightbulb to cool.

5. Do not plug the lamp into multiple power strips as this may overload your electrical system.

6. Do not use the lamp with light dimmers.

7. Do not use for outdoor use.

8. Do not exceed the recommended wattage.

9. If flickering or any other unusual issues occur with your lamp, unplug the lamp from the electrical outlet and contact a qualified electrician.

10. If any external damage occurs on the lamp itself or the lamp cord unplug your lamp from the electrical outlet and contact a qualified electrician to avoid any electric fires and/or injury.

## Security Regulations



**Note:** Do not modify or change the electrical of this lighting as this could result in fire and/or injury. Please follow assembly instructions for installation.

**Safety Precautions (please read fully and follow the instructions before installation)**

1. Please ensure the lamp is not plugged into an electrical outlet when assembling.
2. Do not assemble near wet/damp areas or near gas/exhaust furnaces or fireplaces.

### Care Instructions:

Wipe the external surfaces with a damp cloth. Use a soft cloth to wipe and polish the product, do not use sponges or steel wool. Do not use the following products for cleaning: abrasive household cleaners, acidic and/or alkaline cleaning materials, or household ammonia for cleaning.